

AL-52F-95, AL-72F-95 AL-52FS-95

Home boiler relief valve is installed in plumbing system of heat exchanger, which is used for small hot water boiler operates at pressure less than 100kPa or 200kPa. This valve automatically discharge the water to protect the machinery, when pressure abnormally increase due to water bloat and system trouble.

■Features

1. Big diaphragm at the pressure receiving section enables to blow out large capacity at first operation. Also make the commence-to-blow pressure and reseating pressure stable.
2. The valve is sanitary, since wetted part and mechanical part are separated by diaphragm.
3. Manual lever enables to check the operation and water level. Also quickly discharge water inside the system.
4. Diaphragm is made of heat and water resistance synthetic rubber.
5. AL-72F can easily installed by cap nut, since the outlet connection is parallel screw.
6. AL-52FS is suitable for electric water heater, since the valve seat is made of stainless steel.

■Specifications

Application	Cold and hot water
Commence-to-blow pressure	95 ¹ / ₆ kPa
Reseating pressure	87 kPa or more
Max. temperature	100°C
Body	Bronze
Diaphragm	Synthetic rubber
Connection	AL-52F - 52FS: JIS R 3/4 x JIS Rc 1/2 screwed AL-72F: JIS R 3/4 x JIS G 1/2 screwed

* Please use AL-24F for big size hot water heat exchanger.

* Available with commence-to-blow pressure 60 to 140, 190 for AL-52F and AL-72F, 60 to 100kPa for AL-52FS.

■Dimensions (mm) and Weights (kg)

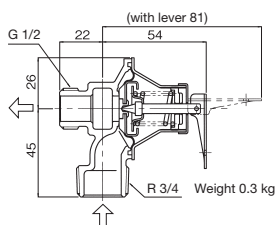
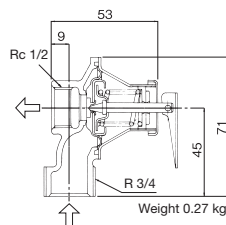

* Part of AL-72F-190 structure is different from above drawing. Dimensions with lever is 86.

* Part of structure except for 95 kPa are different.



AL-52F-95
AL-52FS-95

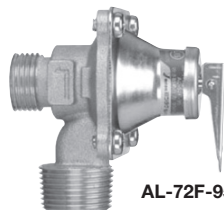

AL-72F-95

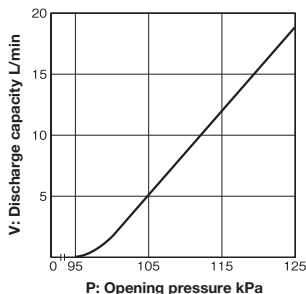

Maximum pressure of Water pressure reducing valve, Relief valve and Hot water heat exchanger

Unit: kPa

Water pressure reducing valve	Relief valve for hot water maker	Max. pressure of hot water heat exchanger
80	95, 97	100
85	97	
120	190	200
150		
170		

Attention Using the bold font valves to simple boiler (100 kPa) is illegal.

■Piping Example

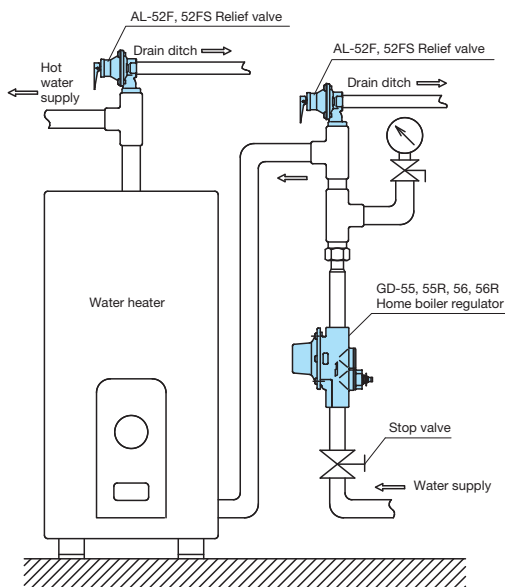

■Precautions for Installation and Operation

1. Please be sure to remove foreign substances and scales from inside of the piping before connecting the product to the piping.
2. Install pipe at the relief valve outlet side and conduct to drain ditch. Also install the relief valve so as to check the operation visually.
3. Relief valve will be opened by lifting the lever horizontally. Please check the operation 1-2 times a month.
4. Styrofoam package can be used as heat insulating material to prevent freezing.