

FV-2

The FV-2 radiator valve is designed to use with radiators for heating using steam.

■Features

1. Totally free of leakage due to bellows pack less type.
2. Complete close with a fluororesin disc.
3. Usable for not only steam but cold and hot water.

■Specifications

| | | |
|---------------------|------------|--|
| Application | | Steam (cold and hot water) |
| Maximum pressure | | 0.3 MPa |
| Maximum temperature | | 150°C |
| Material | Body | Bronze |
| | Union | Brass |
| | Valve disc | Fluororesin |
| Connection | | Inlet: JIS Rc screwed Outlet: JIS R screwed (union joint) |

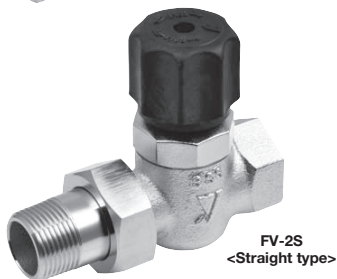

■Dimensions (mm) and Weights (kg)

| Nominal size | d | L ₁ | L ₂ | H ₁ | H ₂ | H ₃ | H ₄ | D | Weight | |
|--------------|-------|----------------|----------------|----------------|----------------|----------------|----------------|----|------------|---------------|
| | | | | | | | | | Angle type | Straight type |
| 15A | 1/2 | 65 | 35 | 28 | 101 | 17 | 95 | 15 | 0.5 | 0.6 |
| 20A | 3/4 | 75 | 38 | 33 | 108 | 21 | 101 | 20 | 0.66 | 0.78 |
| 25A | 1 | 86 | 42 | 38 | 117 | 25 | 109 | 25 | 0.96 | 1.02 |
| 32A | 1-1/4 | 102 | 52 | 44 | 130 | 28 | 117 | 25 | 1.39 | 1.54 |

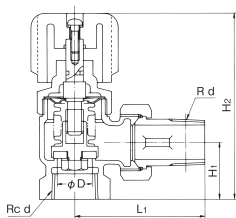

FV-2A <Angle type>

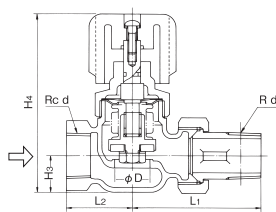

FV-2S <Straight type>

■Maximum Flow Rate Chart (For Steam)

| Nominal size | Differential pressure MPa | | | | | | (kg/h) |
|--------------|---------------------------|-----|------|-----|------|-----|--------|
| | 0.05 | 0.1 | 0.15 | 0.2 | 0.25 | 0.3 | |
| 15A | 16 | 21 | 25 | 30 | 35 | 40 | |
| 20A | 28 | 36 | 44 | 52 | 60 | 71 | |
| 25A | 44 | 57 | 70 | 83 | 98 | 111 | |
| 32A | 64 | 84 | 103 | 122 | 142 | 161 | |

· Since this table shows the maximum discharge, set a sufficient safety factor.